



TINY GRIFFIN  
WELCOME ON BOARD

MIFI:  
Tiny Griffin  
Tinygriffin001  
Harbor Masterr: 00 32 474 46 27 98



Westhoek Marina  
Marinhome Houseboats





On the E40 motorway from Jabbeke to Calais, take exit 4, direction A18-E40 Middelkerke. Turn left at the canal (N358). Follow the canal. Over the bridge to the left : Westhoek Marina. The harbor master's office is on the side of the building.

**CHECKIN:** Preferably between 3pm. and 5 p.m. Brugsevaart 48, 8620 Nieuwpoort. Harbor master: 00 32 474 46 27 98. You have announced your arrival but the harbor master is not there? Don't worry, the barrier will be open and you can enter the boat with the app on your phone or with the digital key in the key box of the boat.



After receiving your keys, return the same way. As soon as you reach the bottom after the bridge, take a 180° field road back.

**PARKING.**

Parking is free in front of the Tiny Griffin.  
Drive the car to the second footbridge. Welcome aboard





**KEYS.**

Upon arrival you will receive a white clicker in a green cover for the boat and a blue one for the barrier from the harbor master.



**BARRIER.**

After receiving your keys, return the same way. As soon as you reach the bottom after the bridge, take a 180° field road back. You open the barrier with the blue badge. The Tiny is the last houseboat in the discreet row of eight.

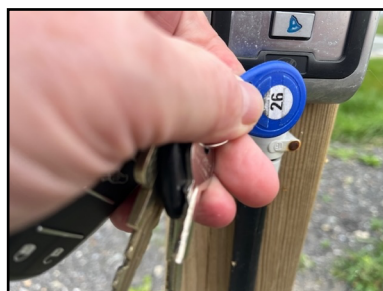

The Tiny Griffin is licensed by logies vlaanderen under the number 398045.



NL

Wenst u meer informatie over de regelgeving rond toeristische logies? Of wil u een klacht indienen tegen dit logies? Neem dan contact op met Toerisme Vlaanderen.

FR

Si vous désirez de plus amples informations sur la réglementation relative à l'hébergement touristique ou si vous désirez déposer une plainte au sujet de cet hébergement, veuillez contacter VISITFLANDERS.

DE

Falls Sie weitere Auskünfte zu den Vorschriften im Bereich der touristischen Unterkünfte wünschen oder falls Sie Beschwerde gegen diese Unterkunft einlegen möchten, kontaktieren Sie bitte VISITFLANDERS.

EN

For more information on the regulation regarding tourist accommodation or if you wish to lodge a complaint about this accommodation, please contact VISITFLANDERS.

TOERISMEVLAANDEREN VISITFLANDERS

Grasmarkt 61 - 1000 Brussels - Belgium  
+32 2 504 04 00

[logies@toerismevlaanderen.be](mailto:logies@toerismevlaanderen.be)  
[www.toerismevlaanderen.be/logiesdecreet](http://www.toerismevlaanderen.be/logiesdecreet)

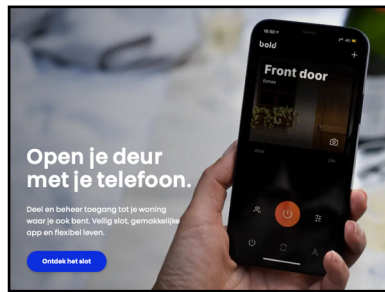

### **BOLD APP**

We will send you an app to install on your smartphone before your departure.

Rather not have an app? Then use the clicker.



### **BOLD CLICKER**

Point the clicker to the doorknob.  
Click :  You will see a green light.  
The knob will be active after 2 seconds.  
The door will not open automatically. You have to turn the knob fully to the right within 20 seconds to open.



### **LEAVING THE TINY.**

Open the entrance door (back terrace).  
Click on the green button.  
Go outside and close the door behind you. Within 20 seconds, turn the outside knob fully to the left. This way the door is in double lock.



### **KEY BOX**

Locked yourself out? No worries.  
The key box holds the key to the front terrace.  
We will give you the code before departure.  
Don't forget to put the key back.



### **MIFI INTERNET**

Tiny Griffin  
pasw: Tinygriffin001

No coverage? Briefly switch the mifi off and on again.

### **FRONT TERRACE DOOR**

Open and close with the rotary knob.  
Remember to close when you go out and at the end of your stay aboard the Tiny Griffin.



### **DOOR TERRACE AT THE BACK.**

Do not leave the door open in wind or rain. The stores may be damaged.  
The inside control knob is not water-resistant.



### **PLEATED CURTAINS.**

There are a lot of glass windows all around. In summer it can be very hot. In that case, shield the windows where the sun shines on with the pleated curtains.



### **PROSIT.**

Enjoy the drinks in the fridge. As well as the Nespresso.



### **THERMOSTAT**

Regulate the temperature yourself.  
Press the sun symbol until you only see this sign :



Adjust with up or down to the desired temperature. Lower the temperature when leaving the Tiny and at night.







### **HOOVER.**

Your boat will be cleaned for you before and after your stay. Do you like to clean it yourself in between? There is a hoover in the technical room.



### **HAIRDRYER.**

Don't like your hair in the wind? Use the Babyliss to neatly style your hair.



### **MICRO WAVE - GRILL**

Never turn on the microwave without content.



### **NESPRESSO**

The Nespresso machine makes the very best coffee.



### **PLIABLE TROLLEY.**

Getting your luggage to the boat in comfort? There is a pliable trolley in the technical area. Do not load more than 70kg.

### **BED LINEN AND TOWELS ARE FREE OF CHARGE.**

The bed on the Tiny Griffin is 1m40 by 2m. On arrival, your bed is made at no extra cost.



### **BOAT TOILET.**

The toilet has a sensitive motor. Throw in only toilet paper. No wet wipes.

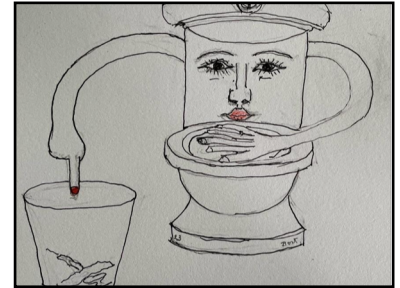

### **HOMA PUMP.**

The HOMA pumps the water away. This may fail very exceptionally. Press AUTO to restart.



### **BICYCLE PARKING.**

Opposite the Tiny is a white container on shore. In it you can safely park your bikes : (not yet applicable).



### **PETANQUE COURSE.**

Ashore, close to the Tiny Griffin, you can enjoy a game of Petanque. There are balls in the technical room. (Coming soon).



## SMARTTV SAMSUNG



The smarttv is hidden in a cupboard behind the dining table. Open the lid and press the button.

The TV pops up electrically.

## SMARTTV TV VLAANDEREN



With TV VLAANDEREN you watch Dutch, French and some English-language channels. Other channels you watch via internet. Ask your TV provider for an app.

## SMARTTV TV VLAANDEREN CHANNELS.



## 03 The Standard Remote Control

Learn where the function buttons are on your remote, such as: SOURCE, TTX/MIX, PRE-CH,  $\nabla$  CH  $\wedge$ , CH LIST, SETTINGS, REC, INFO, RETURN and EXIT.

- This remote control has Braille points on the Power, Channel, Volume, and Enter buttons and can be used by visually impaired persons.
- Depending on the country and model.

**(Power)**  
Turns the TV on and off.

**SOURCE**  
Displays and selects available video sources.

**— VOL +**  
Adjusts the volume.

**MUTE**  
Turns the sound on/off.

**$\nabla$  CH  $\wedge$**   
Changes the current channel.

**CH LIST**  
Launches the Channel List.

**SETTINGS**  
Sets the Quick Settings the menu on the Settings of the home screen.

**(Smart Hub)**  
Launches Home Screen.

**GUIDE**  
Displays the Electronic Programme Guide (EPG).

**PIC SIZE**  
Changes the picture size.

**PICTURE**  
Changes the picture mode.

**AD/SUBT.**  
Displays the Accessibility Shortcuts.

**(Enter)**  
Stops playing content.

**Number**  
Gives direct access to channels.

**TTX/MIX**  
Alternately selects Teletext ON, Double, Mix or OFF.

**PRE-CH**  
Returns to the previous channel.

**REC**  
Records whatever you are currently watching.  
• This function is not available in specific geographical areas.

**INFO**  
Displays information about the current programme or content.

**(Enter)**  
Selects or runs a focused item.

**$\blacktriangle$   $\blacktriangledown$   $\blacktriangleleft$   $\blacktriangleright$**   
Moves the cursor, selects the on-screen menu items, and changes the values seen on the TV's menu.

**RETURN**  
Returns to the previous menu or channel.

**EXIT**  
Exits the menu.

**A, B, C, D**  
Use these buttons according to the directions on the TV screen.

**$\lll$   $\ll$   $\lll$   $\lll$**   
Use these buttons with specific features. Use these buttons according to the directions on the TV screen.

- The button names above may be differ from the actual names.



# GROUND PLAN

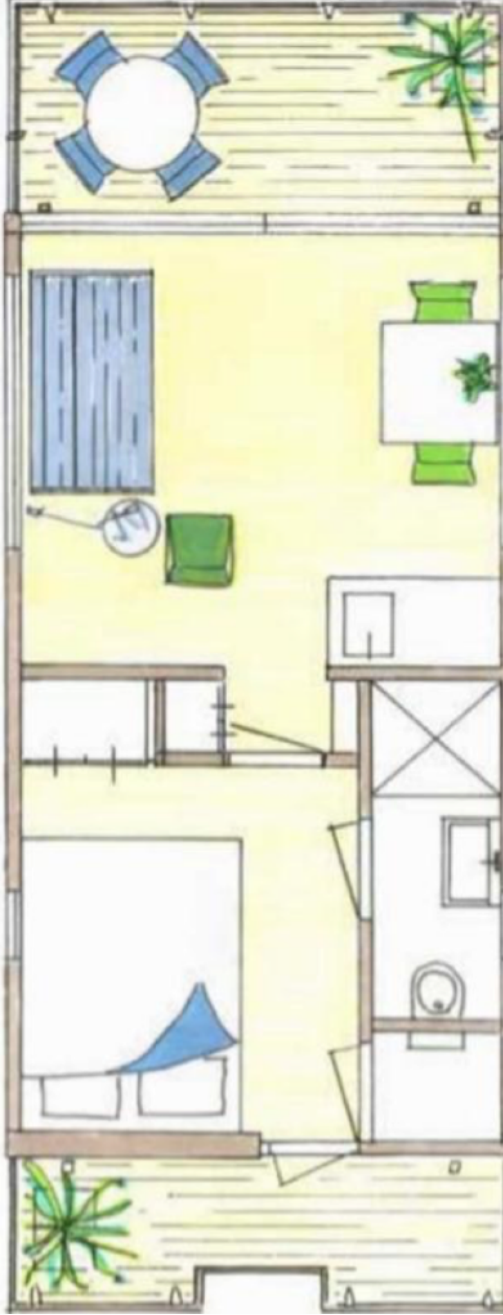

# GROUND PLAN - ESCAPE ROUTE - FIRE EXTINGUISHER

	<p><b>BRANDINSTRUCTIES - CONSIGNES EN CAS D'INCENDIE</b>  <b>INSTRUCTIONS IN CASE OF FIRE - VERHALTEN IM BRANDFALL</b></p> <p><b>No./Nr. 112</b></p> <p><b>1.</b>  <b>Blijf rustig en bel:</b>  Restez calme et appelez le:  Stay calm and dial:  Ruhe bewahren und Brand melden:</p> <p><b>2.</b>  <b>Geef duidelijke informatie over: plaats en omvang van de brand + aantal slachtoffers</b>  Faites clairement mention: de l'endroit et l'importance de l'incendie + nombre de victimes  Give clear information about: The place and the extent of the fire + number of victims  Genau Informationen über Feuer (Was), Ort (Wo) und Opfer (Wie viele) geben.</p> <p><b>3.</b>  <b>Blusapparaat. Blus de brandhaard.</b>  Extincteur. Eteignez le foyer d'incendie.  Fire extinguisher. Extinguish the fire.  Feuerlöscher. Löschersuch unternehmen.</p> <p><b>4.</b>   <b>Sluit ramen en deuren en verlaat de gevarenzone</b>  Fermez les portes et les fenêtres et quittez la zone de danger  Close windows and doors and leave the danger zone  Fenster und Türen schließen und die Gefahrenzone verlassen</p> <p><b>5.</b>  <b>Bij versperring van de normale vluchtweg, gebruik de tweede evacuatieweg. Doe desgevallend de reddingsordels aan. Maak uw aanwezigheid duidelijk.</b>  Si la sortie normale n'est plus accessible, utilisez la 2ème sortie d'évacuation. Mettez vos ceintures de sauvetage si évacuation le long de l'eau. Signalez votre présence de façon claire.  If the regular exit cannot be used, use the 2nd evacuation possibility. Put on the lifebelts when evacuating along the water. Make your presence clear.  Bei Versperrung des normalen Fluchtwegs, den zweiten Fluchtweg benutzen. Ziehen Sie bei der Evakuierung auf dem Wasser die Schwimmwesten an. Machen Sie sich bemerkbar.</p> <p><b>6.</b>  <b>Blijf ter beschikking van de brandweer om verdere informatie te verschaffen</b>  Restez à la disposition des pompiers pour fournir de plus amples informations  Stay available for the firemen to give them further information.  Stellen Sie sich der Feuerwehr zur Verfügung, um weitere Informationen zu erteilen.</p> <p><b>Verantwoordelijke van de uitbating: Responsable de l'exploitation:</b>  <b>Responsible for the exploitation: Für den Betrieb</b></p> <p>Heavenmeester:  +32.474.46.27.98</p>
--	---



***IN THE LIVING:  
THE GANZEPOOT***

The Ganzepoot is a lock complex in Nieuwpoort's inner harbour. Six waterways meet in the complex, which are connected to the North Sea via the Ganzepoot and the estuary of the Ijzer.

The Ganzepoot lock complex dates from the end of the nineteenth century. Seen from above, it has a ground plan in the shape of a goose's foot. Hence the name.

The vannen or outlet locks of the complex allow the low polders to get rid of excess water, while the locks regulate the water level of the canals for the purpose of navigation. The doors of the vannen are closed at high tide; at low tide they are opened to channel excess water to the sea. The actual locks are used for navigation.

The Ganzenpoort played an important role in the First World War.

The Germans were rapidly advancing in Belgium in October 1914. The Allies were in danger of being overrun, so they took a drastic decision. On Sunday 25 October 1914, the flooding of the Ijzervlakte started. The 59-year-old Karel Cogge, dike keeper of Polder Noordwatering Veurne, gives the instructions to bring the plan to fruition. In the presence of King Albert I, Cogge explains to the military commanders at Veurne town hall how to proceed. Hendrik Geeraert, a boatman from Nieuwpoort, along with four military officers, work four nights in a row to manually open the eight openings of the drainage sluice of the 'Ganzepoot', in Nieuwpoort's inner harbour. Each time at high tide, every 12 hours, they open the locks.

On 29 October, the plain between Nieuwpoort and Diksmuide is completely flooded. The result is a status quo. The Belgians dig in on one side, the Germans on the other. There will be no more major offensives; it is the beginning of four years of trench warfare.





**IN THE BEDROOM:  
JAMES ENSOR  
BATHING IN  
OSTEND**

In this coloured etching, Ensor gives his impression of bathing on the beach in Ostend. On the left is a large number of bathing carriages, which one could hire and in which one could change clothes. After a coachman had harnessed the horse for the carriage, he drove the carriage into the water, and when one arrived there well and truly and the stairs had been turned off, the coachman struck the roof with his whip, signalling that the guests could leave the vehicle. Then one could see the ridiculous and monstrous creatures making their way into the water in their striped swimming costumes. For many natives and visitors to Ostend, this was an amusing spectacle. Ensor had a different take on the event. His friend, the literary André de Ridder writes how Ensor unites hundreds of these sea insulting invaders with their flaws and ludicrousness into a madcap dance of fools in the water.